

WIDEX CLEAR™ 220

STAY IN SYNC WITH LIFE

USER INSTRUCTIONS
THE CLEAR™ 220 SERIES

C2-PA

RIC

Receiver-in-canal

YOUR WIDEX CLEAR™ 220 HEARING AID

(To be filled out by the hearing care professional)

Date: _____

Battery size: _____

CONTENTS

SYMBOLS	4
THE HEARING AID	5
Right/left identification.....	9
Acoustic indicators.....	9
The battery.....	10
Inserting the battery.....	10
Low battery indication.....	12
Turning the hearing aid on and off.....	13
Volume adjustment.....	14
Listening programs.....	15
Switching between the listening programs.....	19
Zen+ *.....	19
Using a telephone.....	20
Positioning the hearing aid in the ear.....	21
Removing the hearing aid.....	22
Cleaning.....	23
ACCESSORIES	25
IN CASE OF MALFUNCTION	26
CARING FOR YOUR HEARING AID	29
WARNINGS	30
ADVICE	33
REGULATORY INFORMATION	34

SYMBOLS

The following symbols will be used throughout the manual:



WARNING

Messages with this heading indicate serious adverse reactions, potential safety hazards and inadequate performance of device.



CAUTION

Messages with this heading indicate/include information regarding any special care to be exercised.



 Not for general waste.

THE HEARING AID

The illustration below shows the hearing aid with ear-wire.

1. Microphone openings
2. On/off function
3. Nail grip
4. Earwire
5. Receiver
6. LED

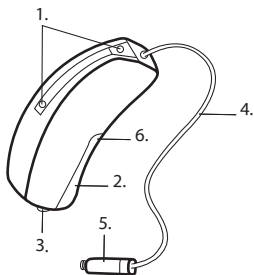

NOTE

In addition to these user instructions, a separate user manual is provided describing the various ear-set solutions available for your hearing aid: “Ear-sets for Widex BTE hearing aids”



WARNING

This booklet and the manual “Ear-sets for Widex BTE hearing aids” contain important information and instructions. Read these booklets carefully before you start using the hearing aid.

NOTE

Your hearing aid, ear-set and accessories may not look exactly as illustrated in this booklet. We also reserve the right to make any changes considered necessary.

Intended use

The CLEAR hearing aids are intended as air conduction amplification devices to be used in everyday listening environments. The CLEAR hearing aids may be provided with the Zen program intended to provide a relaxing sound background (i.e. music/noise source) for adults who desire to listen to such a background in quiet.

Indications for Use

The devices are indicated for individuals with a full range of hearing loss severity from minimal (0 dB HL) to moderately severe (80 dB HL) and all hearing loss configurations.

They are to be prescribed by licensed hearing health-care professionals (audiologists, hearing aid specialists, otolaryngologists) who are trained in hearing (re)habilitation as well as tinnitus management.

Description of device

Your CLEAR™ hearing aid is used with an ear-set which consists of an earwire and an earpiece, in which the receiver is placed. The hearing aid uses a proprietary wireless technology, WidexLink, to enable communication between the left and the right hearing aids, as well as between the hearing aids and the DEX accessories.

Your hearing aid may be provided with an optional listening program called Zen. It makes musical tones (and sometimes a rushing noise) in the background. These sounds are shaped according to your hearing loss.

Right/left identification

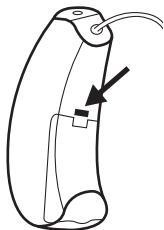

The arrow shows the position of the identification mark (red mark = right and blue mark = left).

Acoustic indicators

The hearing aid may be set to produce a signal to indicate the use of certain functions. The signal may be a spoken message or tones adjusted by the hearing care professional in consultation with you. The signal can also be deactivated.

Adjusting volume		Tone*	Off
Confirming program button use		Clicking sound	Off
Changing program	Message	Tones	Off
Starting up the hearing aid	Message	Tone	Off
Warning about low battery	Message	4 tones	Off
Service reminder	Message		Off

* **Bold** indicates standard setting

The battery

We recommend **zinc-air batteries**. Use a **size 10** battery for the hearing aid.

To obtain replacement batteries, please consult your hearing care professional. It is important to take note of the expiry date and the recommendations regarding disposal of used batteries on the battery pack.



Inserting the battery

Before inserting a new battery into the hearing aid, remember to remove the adhesive tab. Once the tab has been removed, the battery will start functioning after a few seconds.



CAUTION

Do not use batteries if there is a sticky residue from the tab or other unwanted substance, as this can cause the hearing aid to malfunction.



Use the nail grip to gently swing the battery drawer open. Do not press the drawer beyond the open position.

Place the battery in the drawer as illustrated, so that the plus (+) sign on the battery is facing towards you when you hold the hearing aid as shown. You can use the battery magnet provided to steer the battery into place.

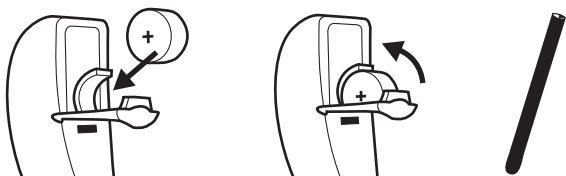

If the battery drawer does not close easily, the battery is incorrectly inserted.

When changing battery, it is a good idea to hold the hearing aid over a table.

Low battery indication

An acoustic indicator will sound when the battery is nearly exhausted, unless this function has been disabled (see page 9). Exactly how long the hearing aid will function after the low battery indication varies from one case to another. We recommend that you always have a spare battery with you.



WARNING

Never leave an exhausted battery in the hearing aid. Exhausted batteries may leak, damaging the hearing aid.



WARNING

Your hearing aid may stop functioning, for instance if the battery is exhausted. You should be aware of this possibility, in particular when you are in traffic or are otherwise dependent on warning signals.

Turning the hearing aid on and off

The battery drawer of the hearing aid also functions as the on/off switch.



Close the battery drawer to turn on the hearing aid. An acoustic indicator will indicate that the hearing aid has been switched on unless this function has been disabled.

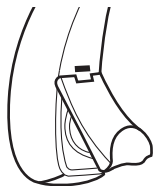

Open the battery drawer to turn off the hearing aid.

Please remember to turn off the hearing aid when it is not in use. Remove the battery if the hearing aid will not be used for several days.

Volume adjustment

The hearing aid volume is adjusted automatically in accordance with your sound environment.

Ordinarily, you cannot fine tune the volume in your hearing aid. However, if you have a remote control, the option of fine tuning becomes available.

Any volume adjustment via the remote control will affect both hearing aids.

For any adjustment of the steps in which volume increases or decreases, consult your hearing care professional.

If you have a remote control, please also refer to the user instructions for this.



CAUTION

If the volume in the hearing aid is generally too loud or too weak, or the reproduced sounds are distorted, or if you would like any further information, consult your hearing care professional.

To mute the hearing aid with a remote control:

Keep pressing the volume down key on the remote control after the long beep-tone has sounded and until it stops. Pressing one of the volume keys briefly will bring back the sound.

Listening programs

By default, your hearing aid has one listening program (Master).

If you have a remote control, three of the following programs, including Master, can be made available, plus the optional Zen program called Zen+. Please also refer to the user instructions for your remote control.

<input type="checkbox"/> Master	Standard
<input type="checkbox"/> Music	For listening to music
<input type="checkbox"/> TV	For listening to the TV
<input type="checkbox"/> Comfort	Attenuates background noise
<input type="checkbox"/> Reverse focus	Focus on sounds from behind
<input type="checkbox"/> Audibility Extender	Makes high-frequency sounds audible
<input type="checkbox"/> Zen <i>(optional)</i>	Randomly plays harmonic tones. Contains one style
Compound programs	The Master program in one ear and Zen, Audibility Extender or Reverse focus in the other
<input type="checkbox"/> _____	
<input type="checkbox"/> _____	
<input type="checkbox"/> _____	
<input type="checkbox"/> Zen+ <i>(optional)</i>	Special Zen program with up to three different Zen styles. Accessed via a long press (two sec.) on the remote control program toggle key

If your needs change over time, the combination of listening programs can be altered.

The optional Zen program may be used with amplification so that both the surrounding sounds and the Zen tones are heard together. Or, it may be used alone (without amplification) in quiet when you are not required to hear surrounding sounds.

The duration of the Zen play time can be set by your hearing care professional according to your needs.

Benefits

The Zen program may provide a relaxing listening background for some people. When the Zen program is used in a tinnitus management program, its wearer may experience some relief from tinnitus.

**CAUTION**

Use of the different Zen programs may interfere with hearing surrounding sounds including speech. The programs should not be used when hearing such sounds is important. Switch the hearing aid to a non-Zen program in those situations.

**CAUTION**

If you perceive decrease in loudness, tolerance of sounds, speech not as clear, or worsening tinnitus, contact your hearing care professional.

Switching between the listening programs

Each time you change program via a remote control, an acoustic indicator will sound unless this function has been disabled.

Program 1: Message or one short beep

Program 2: Message or two short beeps

Program 3: Message or three short beeps

Zen+*: Message or tone

If you change program, the change will apply to both your hearing aids.

Zen+ *

This optional program is accessed via a long press (two secs.) on the program button on the RC-DEX. A short press then allows you to cycle through the available Zen styles.

You can exit Zen+ by pressing and holding the program button on the RC-DEX for two seconds.

* *optional*

Using a telephone

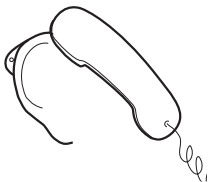

When using a telephone, we recommend that you hold the telephone against your head at an angle above your ear, rather than directly against the ear. If the sound is not optimal, try moving the telephone earpiece to a slightly different position.

Positioning the hearing aid in the ear

Insert the earpiece in the ear canal while holding the lower part of the earwire. It may help to pull the outer ear backwards and upwards with the opposite hand.

Place the hearing aid behind the ear, so that the hearing aid and earwire rest comfortably on the ear, close to your head.

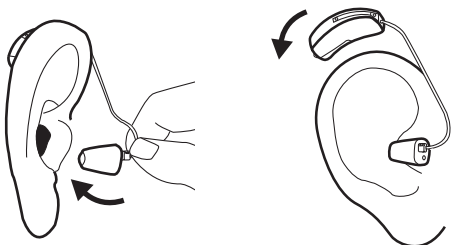

The illustrations show a closed ear-tip. For further information on ear-tip/earmould types, anchors and procedures, see the separate ear-set user manual provided.

Removing the hearing aid

Remove the hearing aid from its position behind the ear.

Carefully pull the ear-tip out of the ear canal, while holding the lower part of the earwire.

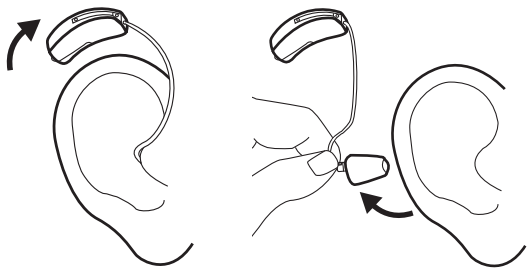

Cleaning

The following cleaning accessories are available for the hearing aid and ear-set*. Please see user manual “Earsets for Widex BTE hearing aids”.

1. Cloth
2. Long wax removing tool
3. Short wax removing tool
4. Brush

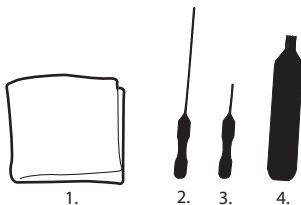

Contact your hearing care professional if you need additional supplies of cleaning accessories.

** Selection depends on your ear-set solution*

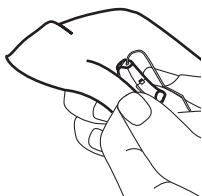

Clean the hearing aid after use with the cloth provided.



WARNING

Never use water or cleaning solutions to clean the hearing aid, as this may cause it to malfunction.

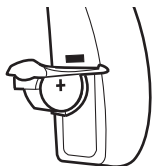

When the hearing aid is not in use, the battery drawer should be left open, so as to ventilate the hearing aid and allow it to dry.

ACCESSORIES

A variety of assistive listening devices are available for your hearing aid.

- RC-DEX
- TV-DEX
- M-DEX

For help in determining whether you could benefit from a remote control or other accessories, please consult your hearing care professional.

IN CASE OF MALFUNCTION

Problem	Potential cause	Solution
The hearing aid is dead	The hearing aid is not turned on	Make sure the battery drawer is closed
	The earwire is broken	Contact your hearing care professional
	The battery is dead or does not work	Insert a new battery in the hearing aid
	The NanoCare wax guard is blocked	Change the wax guard
The hearing aid volume is not powerful enough	The battery is nearly exhausted	Insert a new battery in the hearing aid
	The NanoCare wax guard is blocked	Change the wax guard
	Your ear is blocked by earwax	Contact your ENT doctor/physician
	Your hearing may have changed	Contact your hearing care professional

Problem	Potential cause	Solution
The hearing aid whistles continuously	Your ear is blocked by earwax	Contact your ENT doctor/physician
	The earwire is yellow and stiff	Contact your hearing care professional
	The ear-tip is not correctly placed in your ear canal	Take the ear-tip out and reinsert it
	The ear-tip fit is too loose	Contact your hearing care professional
	The receiver is not adequately secured in the ear-tip	Closed and open ear-tip: Replace the ear-tip. If the problem persists, contact your hearing care professional Custom ear-tip: Contact your hearing care professional
	The receiver is inserted in the wrong hole	Closed ear-tip: Remove the ear-tip and insert the receiver.
Your two hearing aids are not working in synchrony	The connection between the hearing aids is lost	Turn the hearing aids off and on again

Problem	Potential cause	Solution
The hearing aids do not respond with a corresponding change in volume or program to the RC-DEX	<ul style="list-style-type: none"> a. The RC-DEX is used beyond the transmission range (> 1 m) b. Strong electromagnetic interference in the vicinity c. The RC-DEX and the CLEAR hearing aids are not matched 	<ul style="list-style-type: none"> a. Move the RC-DEX closer to the CLEAR hearing aids b. Move away from known source of EM interference c. Check with dispenser to make sure RC-DEX is matched with CLEAR hearing aids
The wearer hears “interrupted” speech (on and off) from the hearing aids or no speech (muted) from the transmitting ear.	<ul style="list-style-type: none"> a. The battery in one of the hearing aids has expired b. Strong electromagnetic interference in the vicinity 	<ul style="list-style-type: none"> a. Replace battery in one or both hearing aids b. Move away from known sources of interference

CARING FOR YOUR HEARING AID

The hearing aid is a valuable object and should be treated with care. Here are some things you can do to prolong the life of your hearing aid:



CAUTION

- Turn off your hearing aid when it is not in use. Remove the battery if the hearing aid will not be used for several days.
- When the hearing aid is not in use, keep it in its case in a cool, dry location out of reach of children and pets.
- Do not expose the hearing aid to extreme temperatures or high humidity. Make sure to dry the hearing aid thoroughly after heavy perspiration such as that which may occur during intense physical activity, e.g. playing sports.
- Avoid dropping your hearing aid – perform cleaning and battery changes while holding the hearing aid above a soft surface.
- Do not wear your hearing aid while in the shower or swimming, or when using a hair dryer, perfume, hair and body sprays or gels such as suntanning lotions or creams.
- In environments with high humidity, a drying kit may be used daily to reduce the amount of moisture inside the hearing aid. See the instructions enclosed with the drying kit .

WARNINGS



WARNING

Hearing aids and batteries can be dangerous if swallowed or used improperly. Swallowing or improper use can result in severe injury or even fatalities. In case of ingestion, contact a physician immediately.

- Keep hearing aids and their parts, accessories and batteries out of reach of children and anyone else who might swallow such items or otherwise cause injury to themselves. Do not change batteries in front of them and do not let them see where you keep your battery supply. Discard used batteries carefully.
- Batteries are very small and can easily be mistaken for pills or the like. Never put a battery or hearing aid in your mouth for any reason as you may risk swallowing it.



WARNING

- Risk of explosion if battery is replaced by an incorrect type or recharged. Dispose of used batteries according to the instructions.
- Never allow others to wear your hearing aid, as this could cause permanent damage to their hearing.
- When selecting a listening program, please remember that there are situations in which it is particularly important to be able to hear the surrounding sounds (e.g. traffic, warning signals).
- The hearing aid is made of modern non-allergenic materials. Nonetheless, in rare cases skin irritation may occur. If you notice skin irritation in or around your ear or ear canal, contact your hearing care professional.



WARNING

- Be aware that the use of any type of hearing aid may involve a slightly increased risk of infection in the ear canal. An infection can arise as a result of inadequate ventilation of the ear. We therefore recommend that you remove the hearing aid and ear-set from your ear at night to allow the ear canal to be ventilated. Make sure that you clean and inspect your hearing aid and ear-set as required. If an infection occurs, you should seek medical attention and contact your hearing care professional for advice on how to disinfect the various hearing aid parts. Do not under any circumstances use alcohol, chlorine or similar substances.
- Widex hearing aids are not certified for use in mines or other areas with explosive gases.



WARNING

- Do not wear your hearing aid during radiation, X-rays, MRIs, CT or other medical treatments and scans. The emissions from these procedures as well as from other types of radiation, such as that in a microwave oven, can damage your hearing aid. Radiation from, for example, room surveillance equipment, burglar alarms and mobile phones is weaker and will not damage the hearing aid but may create audible interference.



CAUTION

- Your hearing aid has been tested for interference according to international standards. Nevertheless, it is possible that unforeseen interference may occur in the hearing aid due to electromagnetic radiation from other products such as alarm systems, room surveillance equipment and mobile phones.
- Although your hearing aid has been designed to comply with the most stringent international electromagnetic compatibility standards, the possibility cannot be excluded that it may cause interference with other equipment, such as medical devices.
- Never try to open or repair the hearing aid yourself.

ADVICE

NOTE

- The hearing aid will not restore normal hearing and will not prevent or improve a hearing loss resulting from organic conditions. However, the hearing aid can help you to make the best possible use of your remaining hearing ability. You should also bear in mind that it can take time to get used to a new hearing aid and new sounds.
- In most cases, using the hearing aid infrequently will not permit you to gain full benefit from it.
- The use of a hearing aid is only part of hearing habilitation and may need to be supplemented by auditory training and instruction in lipreading.
- The use of hearing aids increases the risk of accumulation of earwax. Contact your physician/ENT doctor if you suspect that a plug of earwax has accumulated in your ear. Earwax may not only reduce your own hearing but also the effect of the hearing aid considerably. It is a good idea to ask your physician to clean your ears a couple of times a year.

REGULATORY INFORMATION

Federal Communications Commission and Industry Canada Statement

FCC ID: TTY-C4PA

IC: 5676B-C4PA

This device complies with part 15 of the FCC Rules and with RSS-210 of Industry Canada. Operation is subject to the following two conditions:

- (1) This device may not cause harmful interference, and
- (2) this device must accept any interference received, including interference that may cause undesired operation.

NOTE:

This equipment has been tested and found to comply with the limits for a Class B digital device, pursuant to part 15 of the FCC Rules. These limits are designed to provide reasonable protection against harmful interference in a residential installation. This equipment generates, uses and can radiate radio frequency energy and, if not installed and used in accordance with the instructions, may cause harmful interference to radio communications. However, there is no guarantee that interference will not occur in a particular installation. If this equipment does cause harmful interference to radio or television reception, which can be determined by turning the equipment off and on, the user is encouraged

to try to correct the interference by one or more of the following measures:

- Reorient or relocate the receiving antenna.
- Increase the separation between the equipment and receiver.
- Connect the equipment into an outlet on a circuit different from that to which the receiver is connected.
- Consult the dealer or an experienced radio/TV technician for help.

NOTE:

This equipment complies with FCC radiation exposure limits set forth for an uncontrolled environment. This transmitter must not be co-located or operating in conjunction with any other antenna or transmitter.

This equipment complies with the Industry Canada RF radiation exposure limits set forth for an uncontrolled environment as per IC RSS-102 Issue 3.

Changes or modifications to the equipment not expressly approved by Widex could void the user's authority to operate the equipment.

CE 0459

Hereby, Widex A/S declares that this C2-PA is in compliance with the essential requirements and other relevant provisions of Directive 1999/5/EC.

A copy of the Declaration of Conformity can be found at: <http://www.widex.com>

 **N26346**



Hearing aids, accessories and batteries should not be disposed of with normal household waste. Please consult your national Widex distributor for advice on how to dispose of these items.



CE 0459

Manufacturer

WIDEX A/S • Nymoellevej 6, DK-3540 Lyngø
Denmark • www.widex.com



Printed by HTO / 2011-03
9 514 0171 001 #01